

Part No. 1005194

UWB PCB Antenna with SMA Connector

6.0 – 8.5 GHz



KYOCERA AVX's 1005194 is a versatile off-board UWB PCB antenna optimized for applications spanning 6.0 – 8.5 GHz where off-board implementation is advantageous and necessary. The 1005194 antenna incorporates a rigid mounting structure through an SMA connection allowing for ease of assembly to any device.

**UWB PCB Embedded Antenna**

6000 – 8500 MHz

**KEY BENEFITS**

**Stay-in-Tune**

Ethertronics antenna technology provides superior RF field containment, resulting in less interaction with surrounding components.

**Quicker Time-to-Market**

By optimizing antenna size, performance and emissions, customer and regulatory specifications are more easily met.

**Reliability**

Products are the latest RoHS, WEEE version compliant

**APPLICATIONS**

- Embedded design
- Gateway, Access Point
- Handheld
- Telematics
- Tracking
- IoT, Industrial devices
- Smart Homes
- Agriculture

**Electrical Specifications**

Typical Performance using antenna with SMA connector in Free-space.

Frequency	6.0 – 8.5 GHz
Peak Gain	6.1 dBi
Average Efficiency	85%
VSWR Match	2.0 :1 max
Feed Point Impedance	50 ohms unbalanced
Polarization	Linear
Operation Temperature (°C)	- 40 to + 85
Power Handling	10 Watt

**Mechanical Specifications & Ordering Part Number**

Ordering Part #	1005194-B02
Dimensions (mm)	20.6 x 18.6 x 0.8
Weight (grams)	2.8
Connector	SMA Connector JACK (Female)
Mounting	Screw Mount
Storage Temperature (°C)	- 40 to + 85
Packaging	PE bags

\*Additional variations available with different connectors.

UWB PCB antenna with SMA connector Specifications  
 KYOCERA AVX produces a wide variety of standard and custom antennas to meet user needs.

Typical VSWR, Efficiency and Peak Gain plots

Typical Performance using antenna with SMA connector in Free-space.

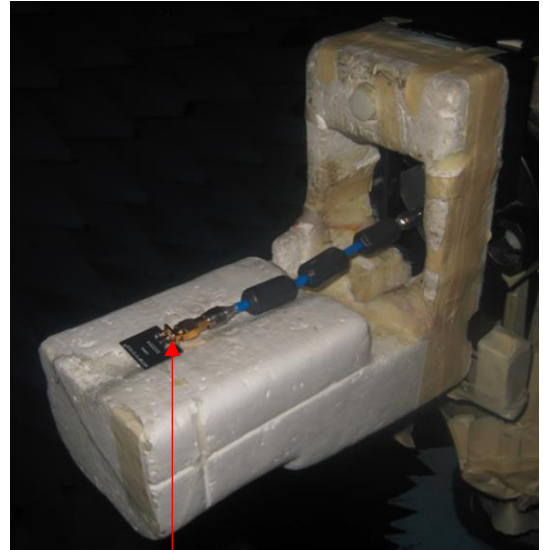
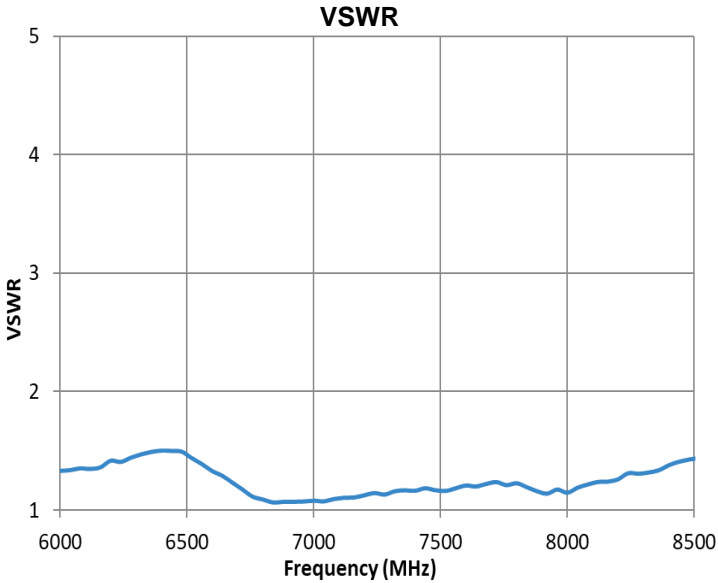

1005194

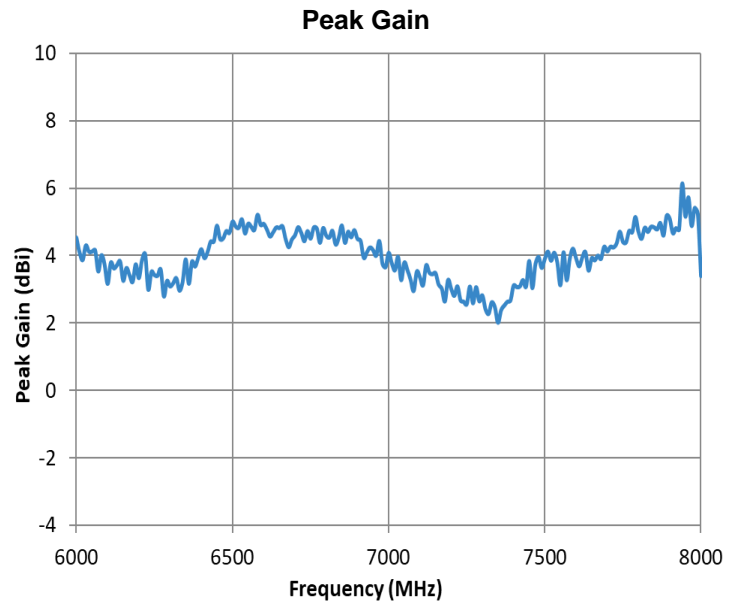
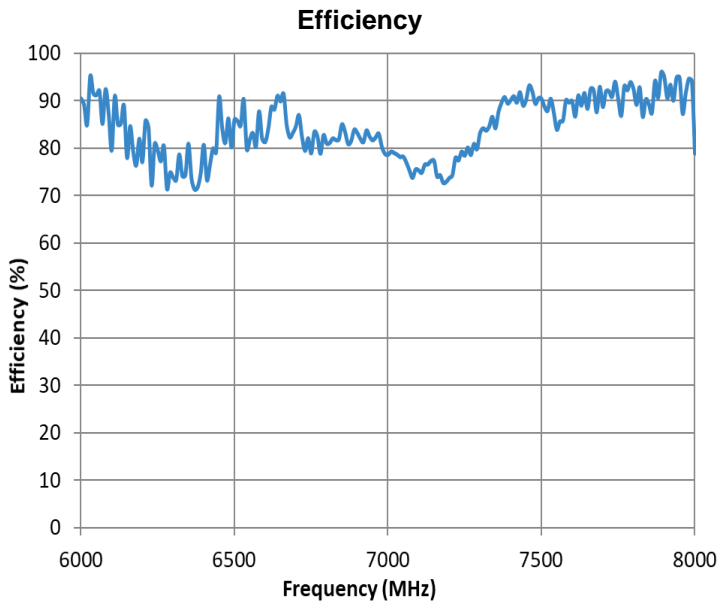

**UWB PCB antenna with SMA connector Specifications**  
 KYOCERA AVX produces a wide variety of standard and custom antennas to meet user needs.

**Radiation Patterns Plots**

Typical Performance using antenna with SMA connector in Free-space.

Typical Performance @ 6500 MHz, 7000 MHz, 8000 MHz

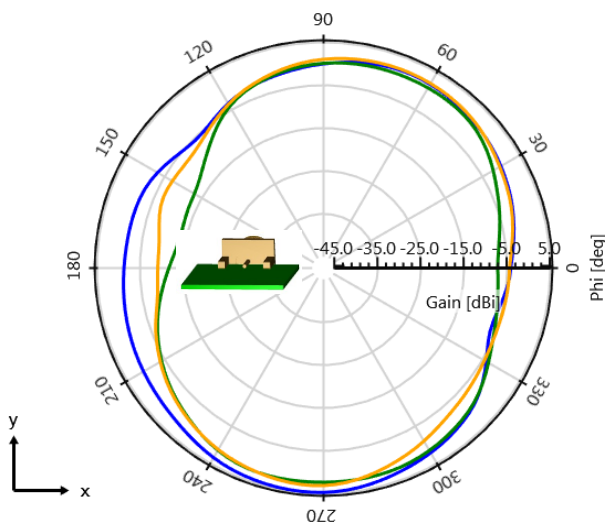
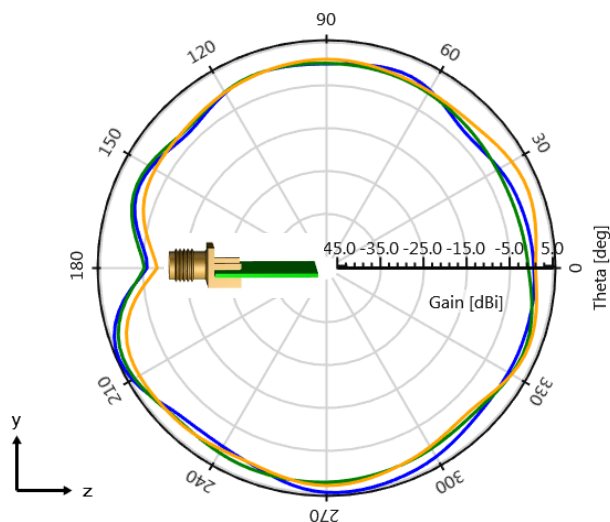
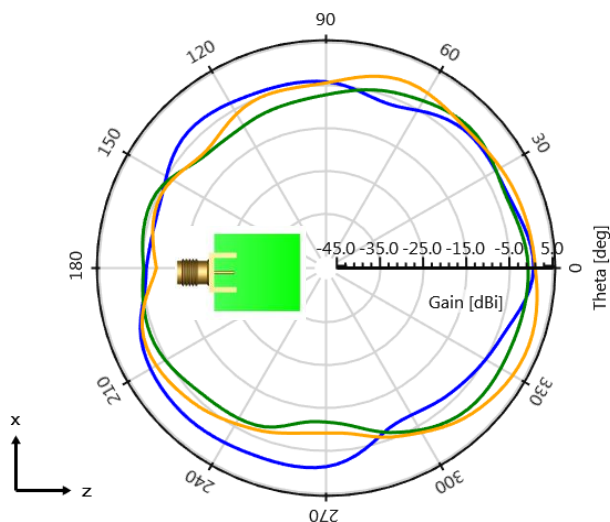
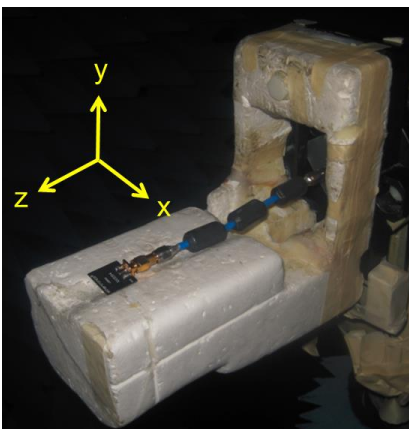
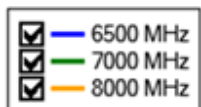

**UWB PCB antenna with SMA connector Specifications**  
 KYOCERA AVX produces a wide variety of standard and custom antennas to meet user needs.

**Mechanical Dimensions**

Typical antenna dimensions (mm)

Part Number	A (mm)	B (mm)	C (mm)	D (mm)	Connector Type
1005194-A01	20.6 ± 0.2	18.6 ± 0.2	0.8	31.5	SMA Male
1005194-B02	20.6 ± 0.2	18.6 ± 0.2	0.8	27.5	SMA Female

\*Additional variations available with different connectors.

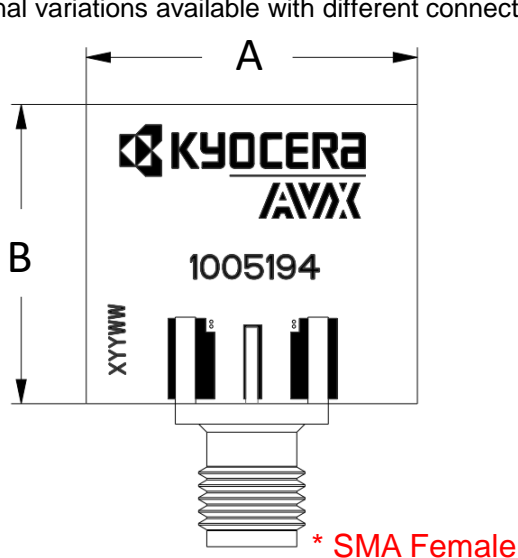

**Top View**

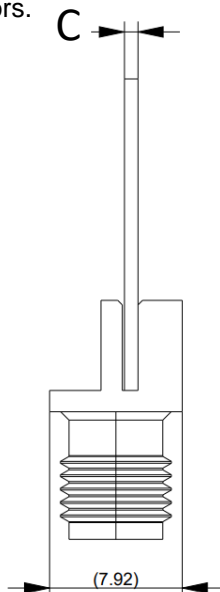

**Side View**

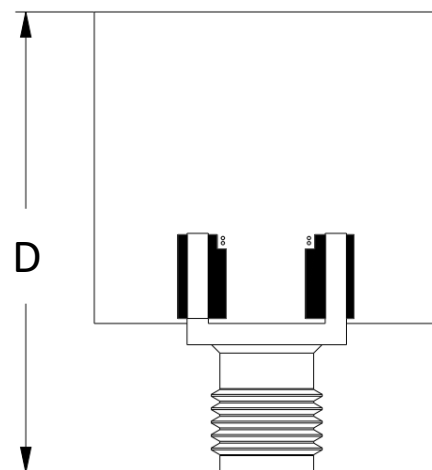

**Bottom View**

